



4.8 Dimensioni

4.8 Dimensions

4.8 Abmessungen

		PA...A - PA...B - PC...B														
		63			80			100			125			160		
A		194			266			331			405			510		
B		97			120			143			164			196		
C2		101			130			155			180			220		
D2 <sub>H7</sub>		25	28	30	30	35	38	40	45	50	55	60	65	70		
E		140			196			242			293			367		
G		68			82			100			118			146		
H		70			98			121			146.5			183.5		
O		61.5			79.5			99.5			123.5			157		
P		30.3			43.9			59.6			72.4			85.1		
R		17.7			20.1			22.4			29.6			41.9		

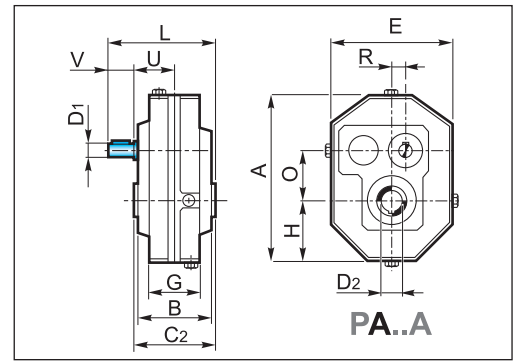

		PA...A				
D1 <sub>h6</sub>		19	24	28	38	48
V		40	50	60	80	80
L		157	194	229	281	342
U		66	79	91	111	152
kg		10	16	28	52	108

		PA...B				
D1 <sub>h6</sub>		14	19	24	28	38
V		30	40	50	60	80
L		138	171	206	241	301.5
U		57.5	66	78.5	91	111.5
kg		12	18	34	58	120

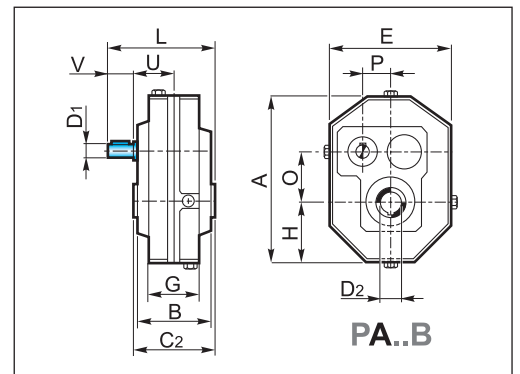

		PC...B							
		63				80			
IEC		63 B5	71 B5	80/90 B5	80 B14	71 B5	80/90 B5	*90 B14	100/112 B5
Y		140	160	200	120	160	200	120 / R 73	250
L1		141	148	168	168	173	193	193	203
U1		90.5	97.5	117.5	117.5	108	128	128	138

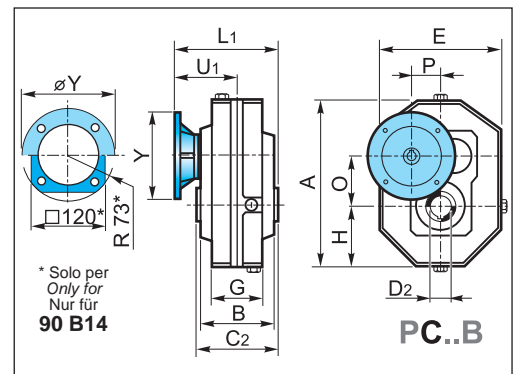

\* Flange quadrata / Square flanges / Viereckige Flansche

		PC...B										
		100			125				160			
IEC		80/90 B5	100/112 B5	132 B5	80/90 B5	100/112 B5	132 B5	160/180 B5	100/112 B5	132 B5	160/180 B5	200 B5
Y		200	250	300	200	250	300	350	250	300	350	400
L1		221	231	253	244	254	276	306	298	348	348	348
U1		143.5	153.5	175.5	154	164	186	216	188	238	238	238

		PA...A						
		63		80		100	125	160
D1 <sub>h6</sub>		19		24		28	38	48
d1		M8		M8		M8	M10	M12
M1		21.5		27		31	41	51.5
N1		6		8		8	10	14

		PA...B				
D1 <sub>h6</sub>		14	19	24	28	38
d1		M6	M8	M8	M8	M10
M1		16	21.5	27	31	41
N1		5	6	8	8	10

		PA...A - PA...B - PC...B														
		63			80			100			125			160		
C2		101			130			155			180			220		
D2 <sub>H7</sub>		25	28	30	30	35	38	40	45	50	55	60	65	70		
M2		28.3	31.3	33.3	33.3	38.3	41.3	43.3	48.8	54.3	59.3	64.4	69.4	79.4		
N2		8	8	8	8	10	10	12	14	14	16	18	18	20		
Z		7.3	7.3	7.3	8.5	8.5	8.5	10.8	10.8	12	12	15.5	15.5	15.5		

Albero entrata  
Input shaft  
Antriebswelle

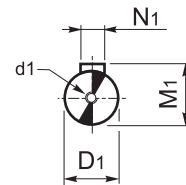

Albero uscita cavo  
Hollow output shaft  
Abtriebshohlwelle

